

SPEEDY DRILL 250 HYDRAULIC

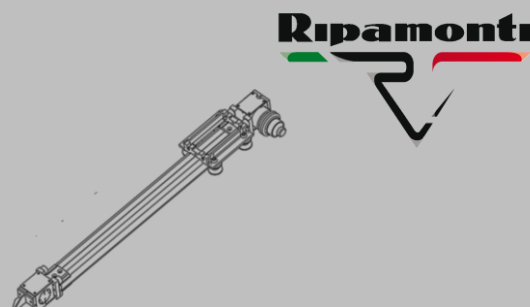

MODEL	STROKE(mm)	PULL BACK (Kg)	MAST LENGHT (mm)	WEIGHT (Kg)
SDI/1300	1.300	1.500/2.250	2.300	75
SDI/1800	1.800	1.500/2.250	2.800	82
SDI/2300	2.300	1.500/2.250	3.300	89
SDI/2800	2.800	1.500/2.250	3.800	96

ROTARY HEADS

RP200/500	
Weight	16 Kg
Oil flow	40 L/min
Torque 140 bar	15,7-7,8 daNm
R.P.M.	300-500
Shank size	1' 1/4UNC



RP200/800	
Weight	16 Kg
Oil flow	40 L/min
Torque 140 bar	15,7-7,8 daNm
R.P.M.	390-780
Shank size	1' 1/4UNC



RP280HS	
Weight	
Oil flow	
R.P.M.	
Torque 180 bar	
Shank size	2.3/8" API REG

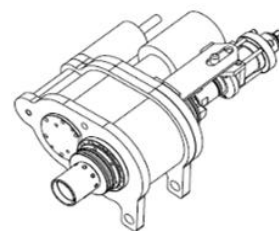

RP500	
Weight	95 Kg
Oil flow	50-80 l/min
R.P.M.	24-48 or 38-76
Torque 180 bar	480-240 daNm
Shank size	2.3/8" API REG

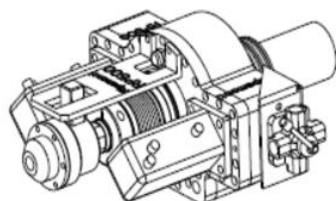

SPEEDY DRILL 250 HYDRAULIC

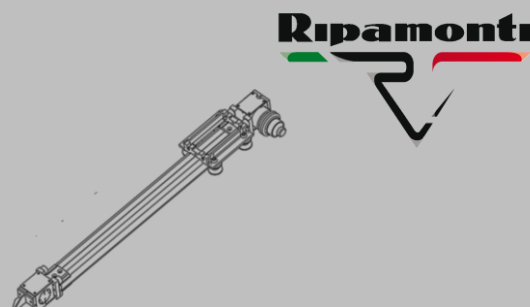

DRIFTERS

Doofor 530 X / L / S	
Weight	65 Kg
Shank size	7/8", R32,R38
Oil flow	60 L/min

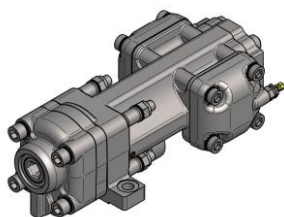

Doofor 538 L	
Weight	83 Kg
Shank size	R32,R38,T38
Oil flow	65-85 L/min

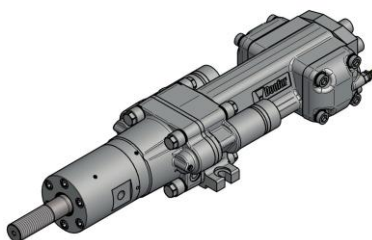

Eurodrill RH1 X / RH 2 X	
Weight	80 Kg
Shank size	R32,R38,T38
Oil flow	40-50 L/min



Eurodrill RH3 X	
Weight	80 Kg
Shank size	R32,R38,T38
Oil flow	40-50 L/min



Eurodrill RH4 X	
Weight	80 Kg
Shank size	R32,R38,T38
Oil flow	40-50 L/min



SPEEDY DRILL 250 HYDRAULIC

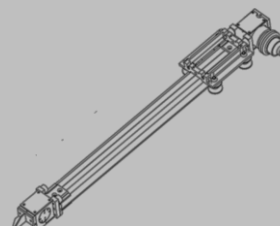

ACCESSORIES

CONTROL PANELS

Manual control panel composed by three Hawe proportional distributors (rotation, feed, free), feed regulator, line lubricator (1 lt.), manual air valve and high-pressure filter including mt. 4 of connection hoses to mast

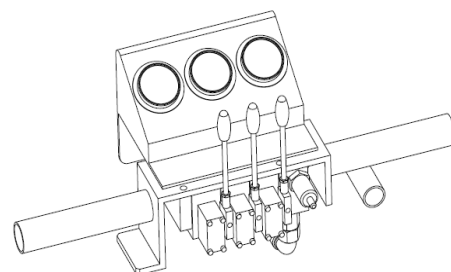

Manual control panel composed by six Hawe proportional distributors (rotation, percussion, feed, free, free, free), feed regulator, line lubricator (1 lt.), manual air valve and high pressure filter including mt. 4 of connection hoses to mast

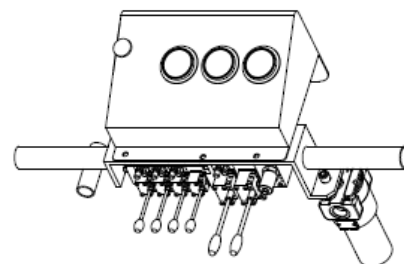

Radio remote control with proportional controls for rotation and feed with air valve opening and start of engine. 20 mt. safety cable

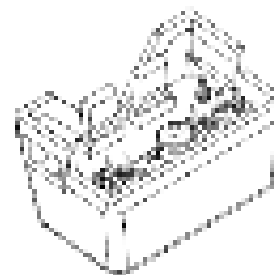

SPEEDY DRILL 250 HYDRAULIC

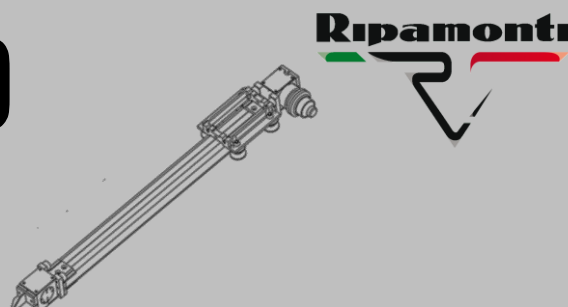

ACCESSORIES:

CENTRALIZERS

Centralizer with disassembly tool for DTH 2",3",

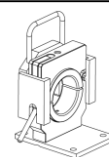

U type centralizer for diam.114mm

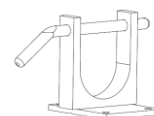

Centralizer HD with disassembly tool for DTH 2",3",4"

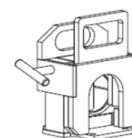

Integral drill steel centralizer 7/8"

Integral drill steel centralizer 1"

Rod centralizer 1.1/4"



Single clamp with extra valve

25-90mm, 50-152mm

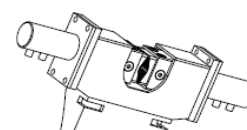

Clamping and breaking device 25-90 with extra valves

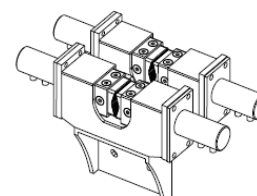

Hydraulic centralizer for rods R25 or R32

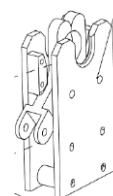

SPEEDY DRILL 180 HYDRAULIC

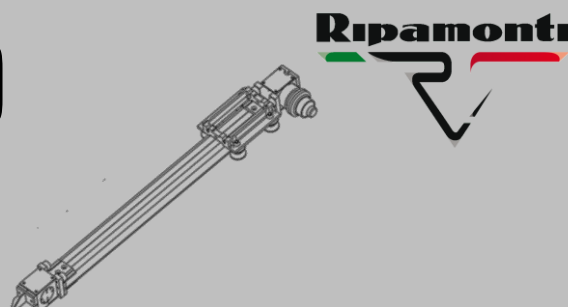

ACCESSORIES:

- Tubular skid frame dismountable version

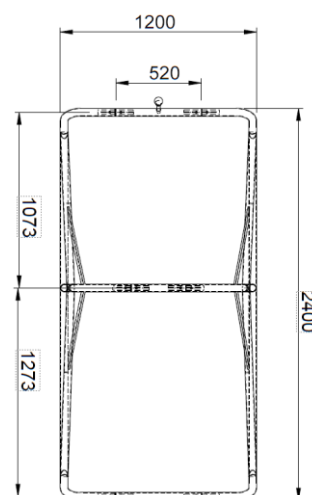
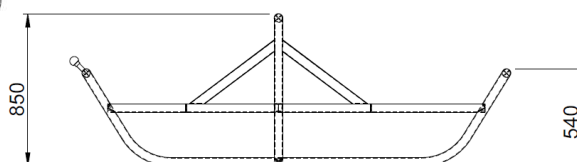
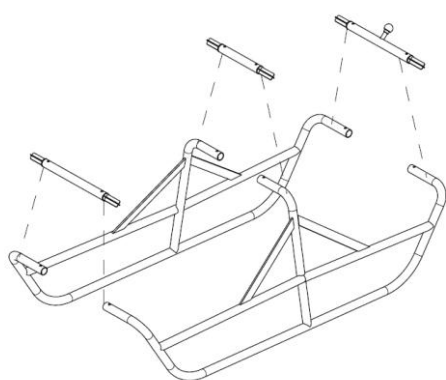

Weight: 60 Kg

- Complete acrobatic sledge with rotation pivot and 2 orientable wheels

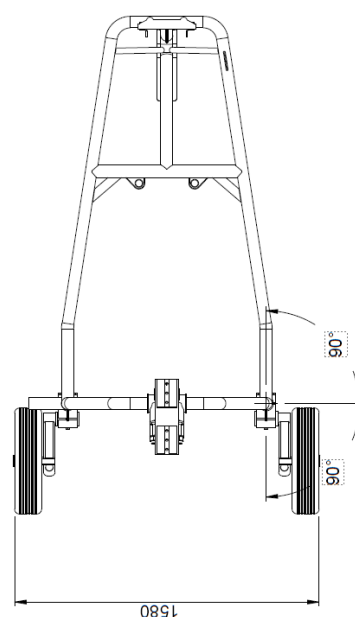
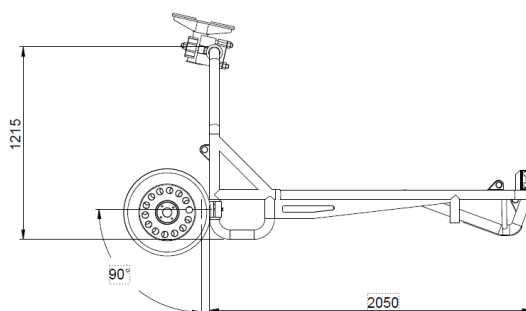

Weight: 160 Kg