



GEOTECHNICAL RIG

Pro480



The Pro480 model is a powerful geotechnical drilling rig (48 HP engine), versatile and with low operation costs.

It is mounted on self-propelled rubber tracks, and equipped for rotary and percussion drilling, as well as coring, down to 60 meters.

With its simple and robust design, this rig is easy to maintain and will be operated in the most difficult job conditions. Very handy with its tracks and low skid, it can easily be used on uneven ground.

Moving the rig on site is performed with a radio remote controller.

A large range of equipment is available. Its variable displacement rotation head offers up to 600 rpm for rotation and a maximum torque of 220 daNm.

It comes as a standard with 4 hydraulic stabilization feet, the skid supporting the rotation head slides with a jack, the mast position can also be vertically adjusted (500 mm stroke). The mast is raised in vertical position using an hydraulic jack, and has a standard useful stroke of 2.5 meters.

Also available are the manipulation winch, the injection swivel, a lateral rod rack, and a rod clamp with 180 mm opening. At last, the rig is equipped with a triplex mud/water injection pump.

Other optional equipment is available, allowing to cover all type of needs :

- Screw type injection pump
- Double rod clamp with untightening jack
- Rotary percussion with top hammer
- Standard SPT hammer or full automatic
- Sensors couplings for drilling parameters recording

The Pro480 rig is equipped with emergency stops on the control panel and on the remote, and safety plates along the mast. It can also be equipped with a protection cage as per CE standard.

Triplex injection pump

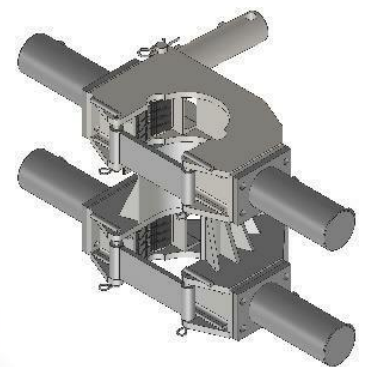



Double rod clamp



GEOTECHNICAL RIG

Pro480

Technical Specifications

Chassis	Welded steel skid, with a self-propelled track 1300 mm wide and 1745 mm long. 4 hydraulic stabilization feet Rig shifting by radio remote control, with an emergency stop	
Engine	Diesel Engine 48 HP YANMAR Stage III (35,4 kW) Air cooling system Gasoil tank 68 litres Hydraulic oil tank 110 litres Triple hydraulic pump Hydraulic oil cooler	 <p><i>Winch and mast bracket</i></p>
Rotation head	Torque : 45 to 220 daNm (mkg) Rotation : 120 to 600 rpm Injection swivel for air and water Translation by motor and double chain Lateral sliding by hydraulic jack : 200 mm	
Mast	Mast with useful stroke 2,55 m (option 3,50 m) Max. height with raised mast = 4100 mm Raising by hydraulic jack with locking in drilling position Push and pull-up force = 2800 kg (28 kN) Mast advance with 500 mm stroke Rod clamp with 180 mm opening	 <p><i>Automatic SPT hammer</i></p>
Safety	Remote controller with emergency stop button Safety plates along the mast Emergency stop on the control panel	
Equipment and options	Double rod clamp Top hammer for rotary-percussion Screw type injection pump Wireline winch 100 m long cable Radio remote controller Standard or automatic SPT hammer Drilling parameters recorder	

Dimensions when drilling

(L x w x h) = 3342 x 1300 x 4846 mm

Dimensions when moving

(L x w x h) = 4255 x 1300 x 2193 mm

Total mass :

2440 kg to 2700 kg (depending on options)