

kmN 1.4

The answer to your biggest underground challenges.

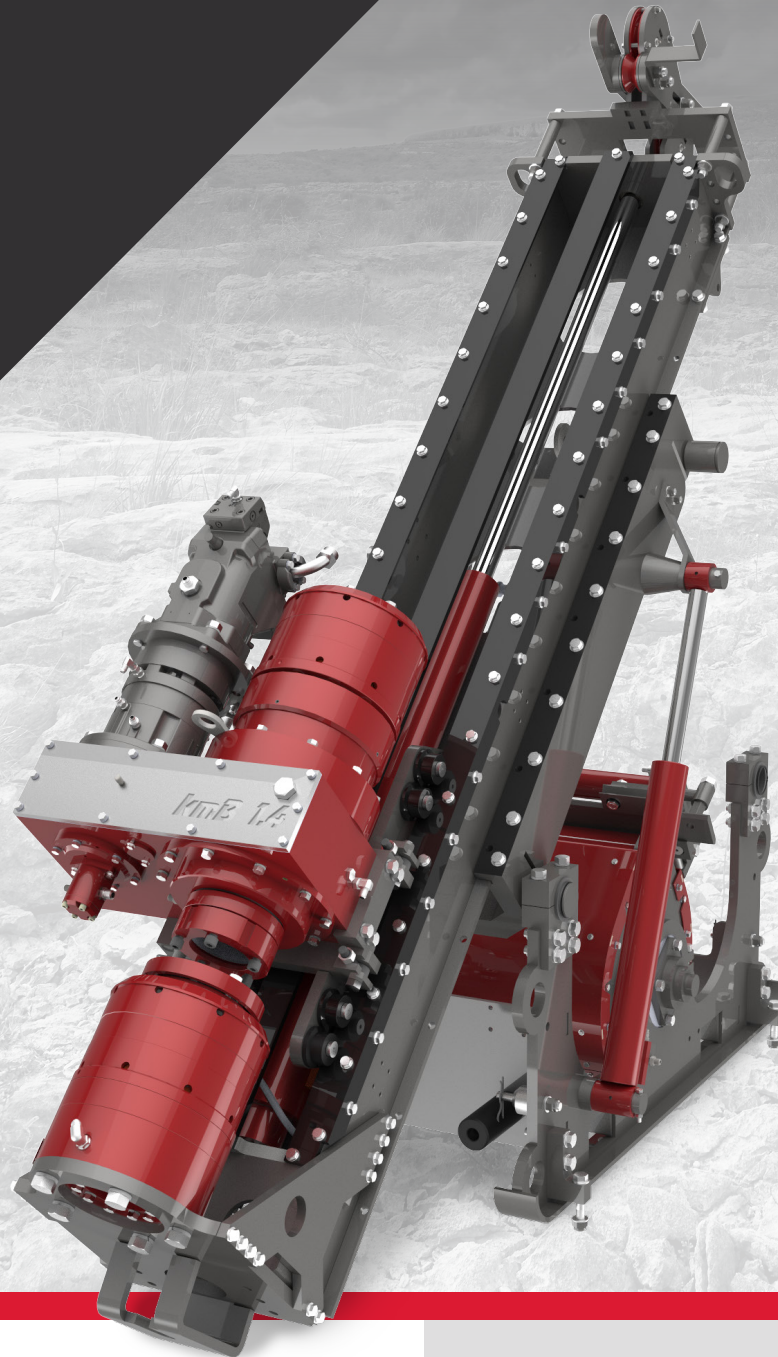

SPECIFICATIONS

Rotary head and chuck

Holding capacity	38 000 lb (17 236 kg)
Spindle interior dimension	4.9" (124 mm) PWL Rod
Chuck operation	Spring closed and hydraulically opened
Final drive	HV 80-3 chain in an oil bath
Hydraulic Motor	160 cc variable
Transmission	HI-LO 2-speed mechanic
Rotary Head Ratio	1:2.33
Lubrication	Pump pressurized, filter and cooler
Speed	0 to 1 250 RPM

FEATURES AND BENEFITS

- Underground (also available in surface version)
- Made of steel
- Depth capacity:
1 400 m (4 600 ft) N size
- Total weight in underground configuration:
14 269 lb (6 474 kg)

kmN 1.4

UNDERGROUND DRILL

Filtration	
10 micron absolute filter on return line (2)	
High pressure filter (2)	
One strainer inside the hydraulic tank connected to the suction (2)	

Hydraulic module	
Floating rotary head Ñ Torque limit on rotary head	
Hydraulic pumps (2)	246 l/min (65 US gal/min) @ 1 800 RPM (max. 4 000 psi (275 bar)) 136 l/min (36 US gal/min) @ 1 800 RPM (max. 4 000 psi (275 bar))
System drive	Open loop, Load-sensing circuit
Hydraulic pressurized tank	55 US gal (208 l)
Oil heat exchanger	Water cooling (Air cooler optional)

Weight	
Electric power unit	2 150 lb (975 kg)
Diesel power unit	1 686 lb (766 kg)
Hydraulic pump and tank	2 634 lb (1 195 kg)
Control panel	672 lb (305 kg)
Drill head	954 lb (433 kg)
Drill head hydraulic motor	70 lb (32 kg)
Drill head transmission	85 lb (39 kg)
Rod holder	452 lb (205 kg)
Feed frame	2 998 lb (1 360 kg)
Mast base	2 679 lb (1 215 kg)
Surface mast	1 541 lb (699 kg)
Wireline	575 lb (261 kg)
Hydraulic hoses	1 000 lb (454 kg)

Drilling capacity		
*Recommended size for maximum performance	*B 2 3/16" (55,6 mm)	6 230 ft (1 900 m)
	*N 2 3/4" (69,9 mm)	4 600 ft (1 400 m)
	*H 3 1/2" (88,9 mm)	2 625 ft (800 m)
	P 4 5/8" (117,5 mm)	1 610 ft (500 m)
Drilling capacity is calculated on a 90 degree down hole and will depend on in-hole tools, ground conditions, drilling techniques and equipment used.		
Recommended electric engine: 125 HP (93 Kw) at 1 800 RPM		
Recommended diesel engine: 205 HP (152 Kw) at 2 100 RPM		

Feed frame	
Head stroke	5 ft 6 in (1,68 m)
Raising speed	143 ft/min (43 m/min)
Lowering speed	143 ft/min (43 m/min)
Pull capacity	26 000 lb (11 800 kg) @ 4 000 psi
Push capacity	26 000 lb (11 800 kg) @ 4 000 psi
Possible angle (Underground version)	-90 to 90 degrees
Possible angle (Surface version)	0 to -90 degrees

Surface mast	
Pull speed	240 ft/min (73 m/min)
Speed of descent	380 ft/min (115 m/min)
Single line pull capacity	12 500 lb (5 670 kg) @ 4 500 psi
Rod pull length	20 ft (6 m)

2-Speed transmission			
Speed	Ratio	RPM	Maximum Torque
LO	3.46:1	0-361	4 196 lb*ft (5 689 N*m) @ 361 RPM
HI	1:1	0-1 250	1 213 lb*ft (1 644 N*m) @ 1 250 RPM
Speed and torque based on a 160 cc hydraulic motor at 4 000 psi (275 bar)			

Wireline hoist	
Cable capacity (3/16 in - 4.8 mm)	6 890 ft (2 100 m)
Empty Pull capacity	2 000 lb (907 kg)
Full Pull capacity	650 lb (295 kg)
Variable speed as needed	

DIMENSIONS

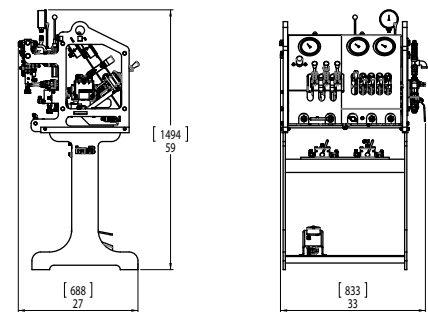
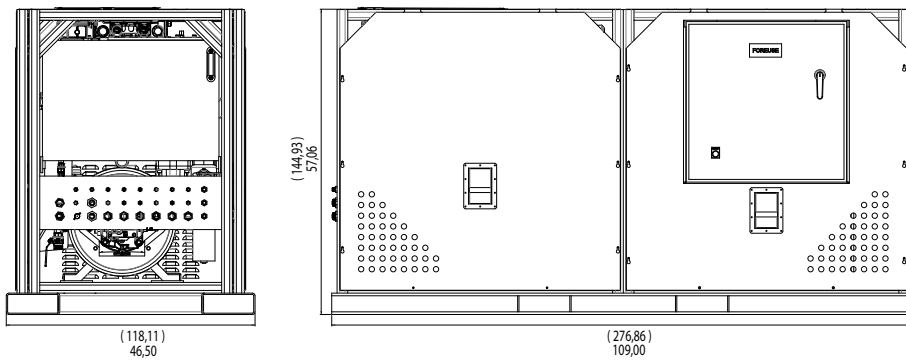
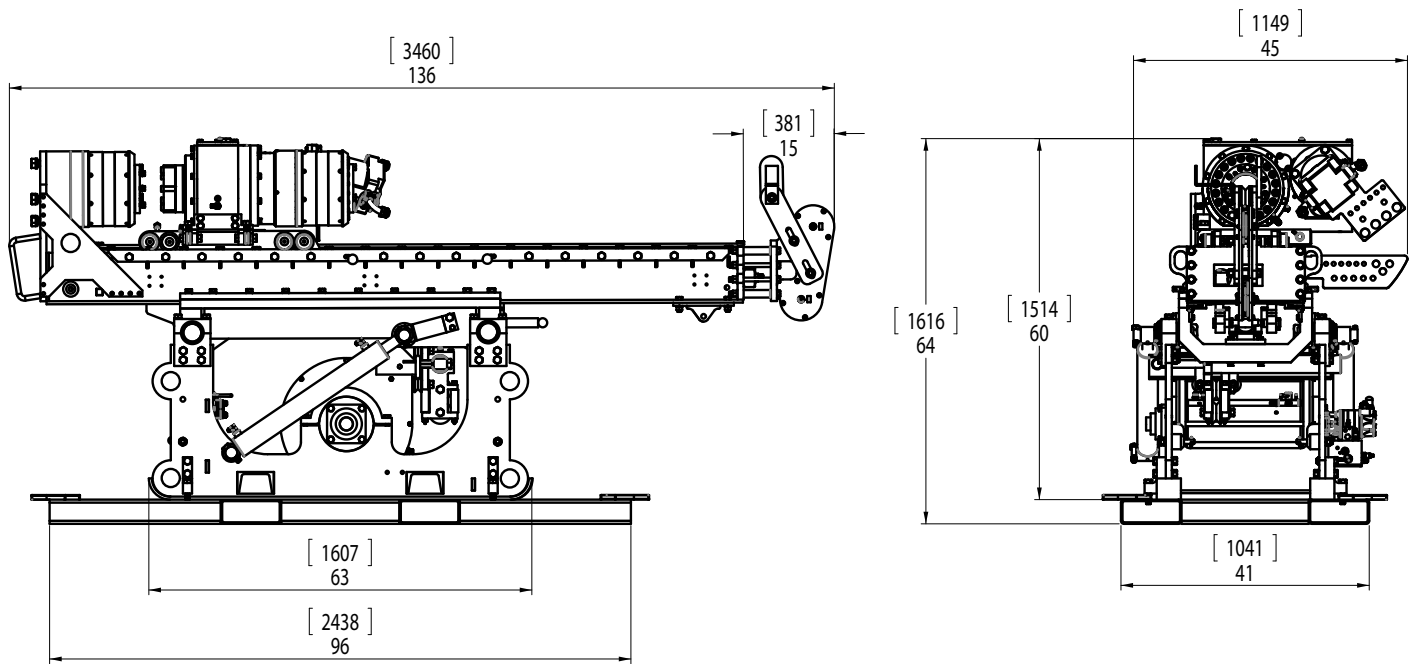



Field experience, **Real** experience.



Distributor:

240, rue Gilbert-Bosse, Val-d'or, QC, Canada J9P 0H4

1 819 874-4404 info@versadrillcanada.com

versadrillcanada.com